

DRY WALL SCREW

Drywall screw is a specialized self-tapping screw with a cylindrical shaft and Philips Bugle Head rather than a slotted head, which provides additional control for installers. These screws can handle multiple fastening and unfastening throughout their product lifecycle.

Features

- ◆ Being fairly thin & curve of bugle head helps **PREVENT DAMAGE** of DRYWALL
- ◆ Black Antirust coating increases **CORROSION RESISTANCE & DURABILITY**
- ◆ Screw fastens flush with the surface, giving a **SMOOTH & EVEN FINISH**
- ◆ Sharp point assists **FAST & EASY DRILLING**
- ◆ Relatively **ECONOMICAL**

Applications

- ◆ Securing drywall sheets to ceiling joists, wall studs, metal tracks and more.
- ◆ Fastening iron joints and wooden products.

CRITICAL INSTALLATION INSTRUCTIONS

- ◆ Clean any metal shavings build-up on the bit after-which attach a screw with screwdriver bit.
- ◆ Slow press trigger till drilling tip of the screw rests against metal. Increase speed when screw aligns to center.

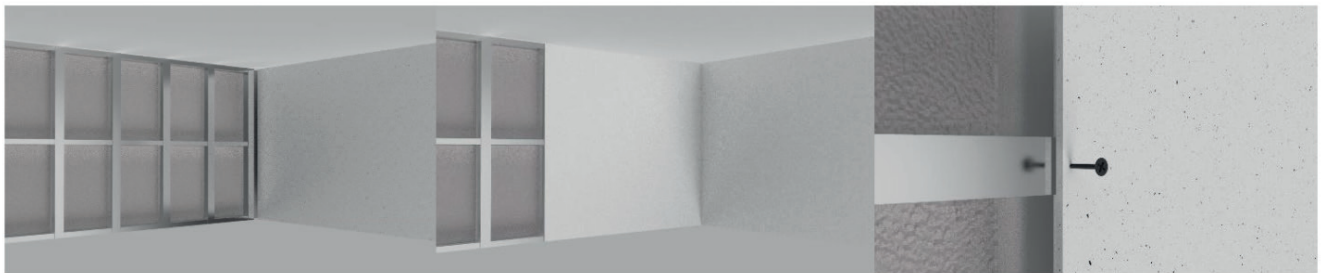

Material Specifications

Parameter	Specifications
Diameter Range	3.5mm (#6)
Length Range	13mm – 75mm
Coating	Black Antirust
Thread Type	Coarse Thread
Fitting Accessory	Screwdriver Bit PH2 (S2 x 65mm)
Drilling Capacity	0.70-1.00mm

