

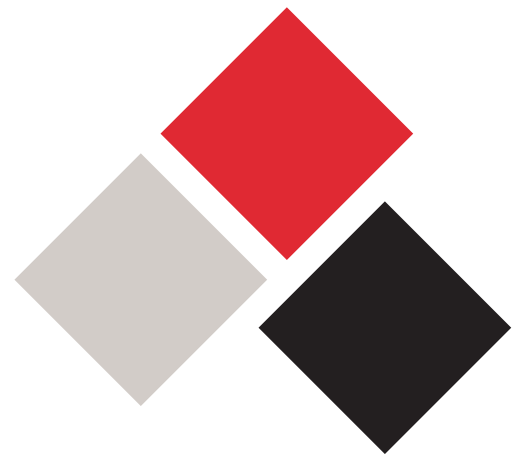

HOLDING
INDIA TOGETHER
FASTENERS AND FIXINGS







CONTENTS

Company Introduction	1
Wedge Anchor	2 - 3
Hit Anchor	4
Drywall Screw	5
Self Drilling Screw (SDS)	6
Hex Head SDS	7
Countersunk Head SDS	8
Pan Head SDS	9
Truss Head SDS	10
Miscellaneous Products	11



INTRODUCTION

We at Welfast, are a quality conscious enterprise dealing in Specialized Anchor Fasteners, High Tensile Bolts (Grade 8.8), Self-Drilling Screws, Drywall Screws and other allied products. Incepted in 1957 by Mr. Pratap Rai Mehta in the name of Indian Steel Corporation, we have been serving the fastener fraternity for over 65 years.

We started out with dealing in High Tensile Bolts and slowly and steadily added 15+ products under our belt. We now manufacture Wedge Anchors, Pin Type Anchors, Drywall Screws, Countersunk Head Self Drilling Screws & High Tensile Bolts and import Hex Head Self Drilling Screws, Pan/Truss Head Screws, Nylon Frame Fixing Anchors, Drop-in Anchors, Sleeve Anchors & more.

We have vertically integrated from being just a retailer in Kolkata, to being a manufacturer & importer with multiple branches, 150+ Passionate Employees & over 2000+ active clients.

Our goal is to provide fasteners which are superior in quality & affordable in prices to our deserving clients. We aspire to manufacture as many import substitute products as we can to grow ourselves and also the Indian fasteners fraternity.

WHY CHOOSE US?



◆ Availability & Wide Product Range

We have a wide range of products with over 500+ products permanently in stock, at our facilities in Kolkata & Ahmedabad (over 50000 ft²), to ensure fast delivery to any part of the country.

◆ Deal Directly with a Manufacturer/Importer

We like to optimize not only our product but also our supply chain. We love to get immediate feedback directly from our users. We can even co-pack for your brand!

◆ We are passionate about Fasteners

We dream & breathe fasteners. If you have a fastener problem, it's our problem. With a team of over 150+ affable employees, we will definitely find a way out.

◆ Guaranteed Quality

With a completely inhouse manufacturing system, we do everything from wire drawing, forging, threading, heat treatment, stress relief, plating, packaging & quality control within our premises to ensure quality checks at each step.

WEDGE ANCHOR

Wedge Anchors, also known as Expansion Anchors, are characterized by having an expansion clip. Application of torque to the anchor, expands the clip on the cone shaped bolt, resulting in pressure on the inner side of the hole. This leads to necessary friction between the expansion clip & the base material, completing the installation.

Suitable for

- ◆ Concrete
- ◆ Dense Natural Stone

Key Features

- ◆ Affordable and Easy installation.
- ◆ Dual embossments on each clip segment: Enables clip to undercut into the concrete thereby increasing follow-up expansion should a crack occur.
- ◆ In addition to superior fatigue resistance, a spring-steel clip offers "memory" that contributes to the anchor's performance if the hole increases in size because of a crack.
- ◆ High Resistance Values.

INSTALLATION INSTRUCTIONS



Critical Installation Recommendations

- ◆ Ensure correct expansion of the anchor by applying recommended torque values.
- ◆ Maintain cleanliness of the hole.
- ◆ Hammer in the bolt only after aligning the nut with the taper end section on the head of the anchor body to prevent any thread damage.
- ◆ As a rule of thumb, we recommend a minimum standard of ten (10) anchor diameters for spacing between anchors and five (5) anchor diameters from an unsupported edge.

WEDGE ANCHOR

Material Specifications

Anchor Part	Material
Anchor Bolt	Carbon Steel (Grade 4.6)
Expansion Sleeve	Spring Steel
Nut (Hex Nut)	Carbon Steel
Washer (Plain)	Carbon Steel
Finish	Electroplated Zinc

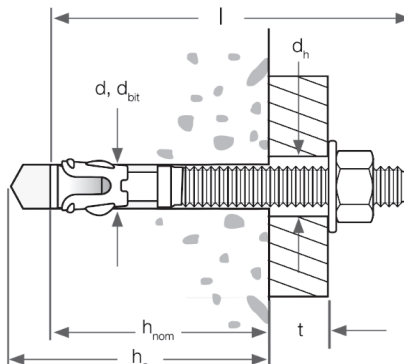

Suitable for: Concrete

Parameter	Legend	Unit	M8	M10	M12	M16
Drill Hole Diameter	d	(mm)	8	10	12	16
Tightening Torque	T_{inst}	(mm)	15	30	50	100
Cutting Diameter of Drill Bit	$d_{cut} \leq$	(mm)	8.35	10.45	12.5	16.5
Drill Hole Depth	h_o	(mm)	52	65	78	104
Dia of Clearance Hole in Fixture	d_h	(mm)	10	12	14	18
Recommended Anchorage Depth	h_{nom}	(mm)	40	50	60	80
Fixture Thickness	t	(mm)	0-55	0-80	0-125	0-154
Min. Base Material Thickness		(mm)	100	120	140	170

Performance Data (For a Single Anchor)

- ◆ Concrete C 20/25
- ◆ No edge distance and spacing influence

Parameter	M8	M10	M12	M16
Ultimate Tensile Load (kN)	12.7	17.7	23.1	49.2
Ultimate Shear Load (kN)	8.8	16	21.4	48.3
Recommended Tensile Load (kN)	2.4	4.4	5.7	12.3
Recommended Shear Load (kN)	2.9	4	5.3	12.0

HIT ANCHOR

Welfast Fasteners specializes in Hit Anchors for push through applications. Hit Anchors are impact expansion type concrete anchors with an interior hole extending the length of the anchor. A hardened drive pin comes along the assembly inserted in the bolt. The anchor is threaded on the upper portion where the drive pin is inserted. Other end of the anchor has four equally spaced slots for a portion of its length, with ribs extending the circumference of the anchor for a portion of its length.

INSTALLATION INSTRUCTIONS



Material Specifications

Anchor Part	Material
Anchor Bolt	Carbon Steel / Stainless Steel (Grade 4.6)
Nut (Hex Nut)	Carbon Steel / Stainless Steel
Washer (Plain)	Carbon Steel / Stainless Steel
Finish	Electroplated Zinc (Yellow)

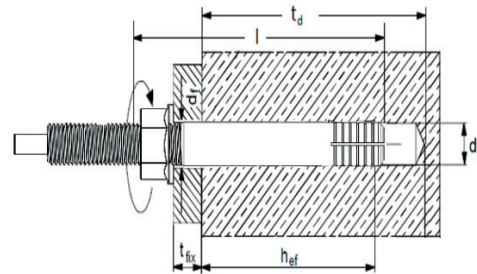

Suitable for: Concrete

Parameter	Legend	Unit	M8	M10	M12	M16	M20
Drill Hole Diameter	d	(mm)	8	10	12	16	20
Length Range Available	l	(mm)	75-100	75-150	75-200	75-250	75-300
Cutting Diameter of Drill Bit	$d_0 \leq$	(mm)	8.35	10.45	12.5	16.5	20.5
Drill Hole Depth	t_d	(mm)	47	60	78	104	120
Dia of Clearance Hole in Fixture	d_f	(mm)	10	12	14	18	22
Recommended Anchorage Depth	h_{nom}	(mm)	35	45	60	80	90
Fixture Thickness	t_{fix}	(mm)	0-55	0-80	0-125	0-154	0-191
Min. Base Material Thickness		(mm)	100	120	140	170	200

DRY WALL SCREW

Drywall screw is a specialized self-tapping screw with a cylindrical shaft and Philips Bugle Head rather than a slotted head, which provides additional control for installers. These screws can handle multiple fastening and unfastening throughout their product lifecycle.

Features

- ◆ Being fairly thin & curve of bugle head helps **PREVENT DAMAGE** of DRYWALL
- ◆ Black Antirust coating increases **CORROSION RESISTANCE & DURABILITY**
- ◆ Screw fastens flush with the surface, giving a **SMOOTH & EVEN FINISH**
- ◆ Sharp point assists **FAST & EASY DRILLING**
- ◆ Relatively **ECONOMICAL**

Applications

- ◆ Securing drywall sheets to ceiling joists, wall studs, metal tracks and more.
- ◆ Fastening iron joints and wooden products.

CRITICAL INSTALLATION INSTRUCTIONS

- ◆ Clean any metal shavings build-up on the bit after-which attach a screw with screwdriver bit.
- ◆ Slow press trigger till drilling tip of the screw rests against metal. Increase speed when screw aligns to center.

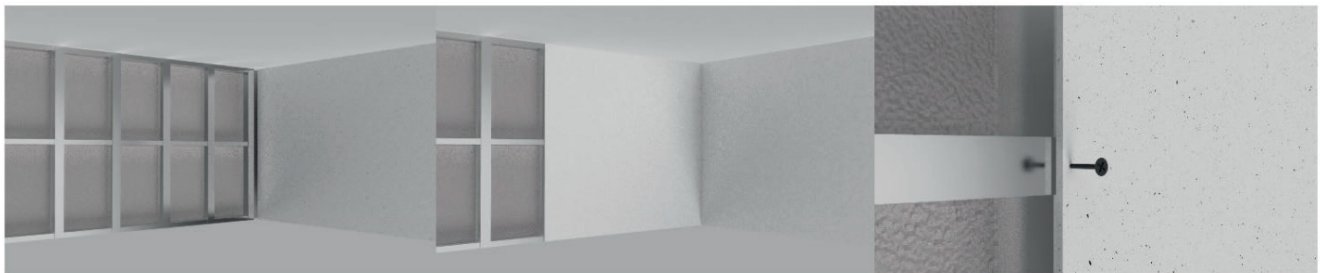

Material Specifications

Parameter	Specifications
Diameter Range	3.5mm (#6)
Length Range	13mm – 75mm
Coating	Black Antirust
Thread Type	Coarse Thread
Fitting Accessory	Screwdriver Bit PH2 (S2 x 65mm)
Drilling Capacity	0.70-1.00mm

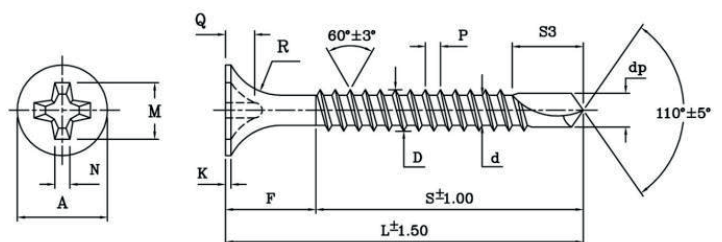

SELF DRILLING SCREW

Engineered to consistent performance and speed, Welfast Self Drilling Screws offer quality with precision. These are cold formed with rolled thread for superior strength and fast drilling performance. Strictly adhering to DIN Standards, Welfast Self Drilling Screws are available in a dynamic assembly of Hex, CSK-Philips, Truss & Pan Heads with lengths ranging from 13mm – 150mm. Additional options of thread types, drilling point lengths and coating value adds to selection.

Features

- ◆ Single drilling process eliminates the need of alignment or pre-drilled holes ensuring **PRECISION**.
- ◆ Smooth threads allow easy self-tapping through the structure with **MINIMAL EFFORTS**.
- ◆ Allows fastening to both, timber and steel, giving **DUAL FUNCTIONALITY**.

Material Specifications

Parameter	Specifications
Material	C1022 – Case Hardened Steel
Head Type	Hex, CSK, Truss & Pan
Coating	Blue Zinc / Xylan-Dacromet Coated
Thread Type	Coarse / Fine / Double-Thread
Fitting Accessory	Hex Magnetic Nut Setter (M8x50/65)

Mechanical Data

Size	Drill Point	Drill Capacity (mm)
M3.9 (#7)	#2	0.5-1.0 mm
M4.2 (#8), M4.8 (#10)	#2	1.0-2.0 mm
M4.8 (#10)	#3	1.0-3.0 mm
M5.5 (#12)	#3.5 #4	2.0-4.5 mm 6.0-7.0 mm

THREAD TYPES

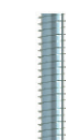

COARSE



FINE



DOUBLE

HEAD TYPES



HEX



CSK



PAN



TRUSS

SURFACE FINISH

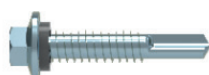

BRIGHT ZINC



DACROMATE

DRILL POINTS



#2



#3



#3.5



#4

HEX HEAD SDS

WELFAST Hex Head Self Drilling Screws, also referred to as roofing screws, are used for metal to metal fastening. Screws are case hardened during heat treatment to ensure fast & easy drilling while maintaining increased strength and holding abilities. These screws come with rubber washers to provide a long lasting water proof seal.

Features

- ◆ Point to Thread Design maximizes pullout performance.
- ◆ Improved TPE Washer provides a Water Proof Seal.
- ◆ Xylan/Dacromet coating for Anti Corrosion.

Applications

- ◆ Point #3 screws for light purpose use like stitching roof decks to wall panel.
- ◆ Point #3.5 screws for medium usage like roofing sheets to steel frames.
- ◆ Point #4 screws for heavy duty use like metal deck to structural steel.
- ◆ Xylan/Dacromet screws for humid or alkaline location.

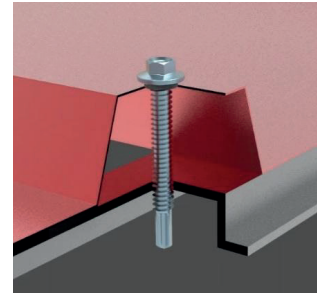

INSTALLATION INSTRUCTIONS

- ◆ Insert and center 8mm hex nut setter in the drill machine's chuck.
- ◆ Check for any metal shavings build-up inside the nut-setter after-which place a screw into the hex adapter.
- ◆ Slow press trigger till drilling tip of the screw rests against metal. Increase speed when screw finds center.
- ◆ Stop drilling when the head of the self-drilling screw tightens against the surface of the metal.

Material Specifications

Parameter	Specifications
Diameter Range	4.8mm (#10), 5.5mm (#12)
Length Range	19mm – 150mm
Coating	Blue Zinc / Xylan-Dacromet Coated
Thread Type	Coarse / Fine / Double-Thread
Fitting Accessory	Hex Magnetic Nut Setter (M8x50/65)

Specifications

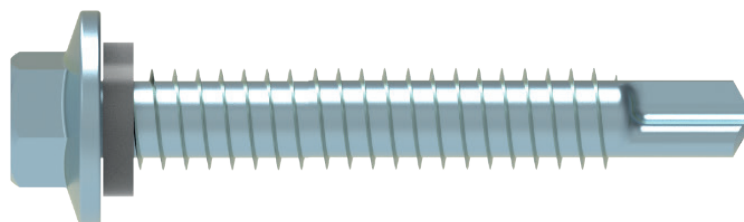
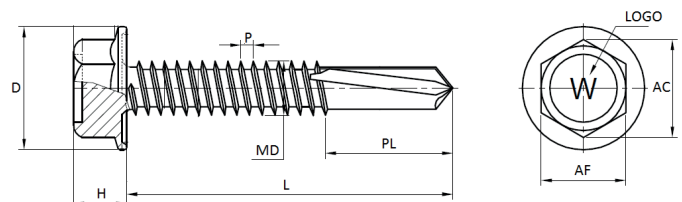

COUNTER HEAD SDS

WELFAST CSK(Countersunk) Head Self Drilling Screws have a sheet metal thread with a self-driller cutting (TEK) point to pierce through 20-to-14-gauge metals. All are beveled under the head for use in countersunk holes. They save you time and effort by drilling their own holes and fastening in a single operation. Installation requires use of Philips Driver #2.

Features

- ◆ Accurate cutting edges improve drill performance with **LESS EFFORT & PRECISION.**
- ◆ Flat head gives a fine finish and thus **ASTHETICALLY PLEASANT LOOK.**
- ◆ Additional RIBS give fastening a **BETTER GRIP.**

Applications

- ◆ Fastening in window or door frames.
- ◆ Flush fit requirement.
- ◆ Using in pre drilled holes for fitting.

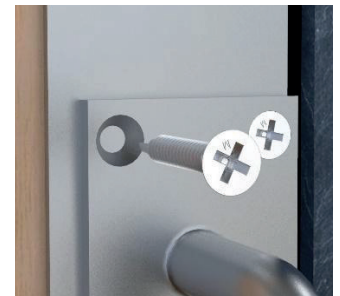

INSTALLATION INSTRUCTIONS

- ◆ Insert and center Screwdriver Bit PH2 (S2 x 65mm) in the drill machine's chuck.
- ◆ Clean any metal shavings build-up on the bit after-which attach a screw with screwdriver bit.
- ◆ Slow press trigger till drilling tip of the screw rests against metal. Increase speed when screw aligns to center.
- ◆ Stop drilling when the head of the self-drilling screw tightens against the surface of the metal.

Material Specifications

Parameter	Specifications
Diameter Range	3.9mm (#7), 4.2mm (#8), 4.8mm (#10)
Length Range	13mm – 100mm
Coating	Blue Zinc Coated
Thread Type	Coarse Thread
Fitting Accessory	Screwdriver Bit PH2 (S2 x 65mm)

Specifications

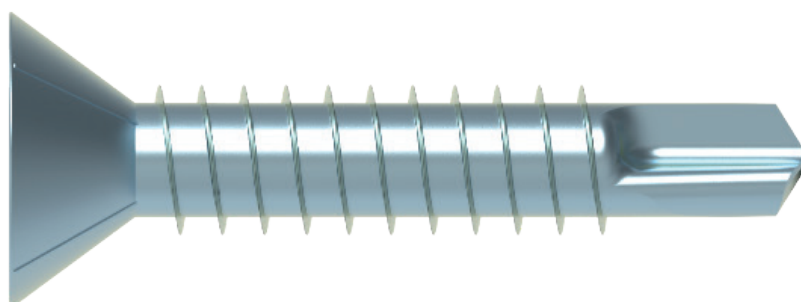
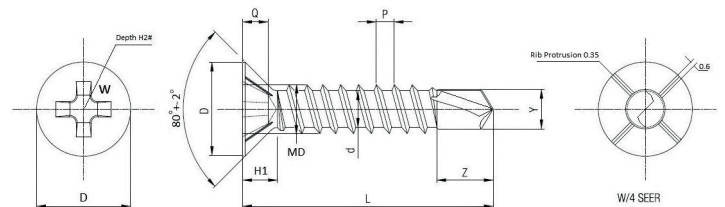

PAN HEAD SDS

WELFAST PAN Head Self Drilling Screws feature a lower profile than oval or round screws, flat or slightly rounded top and sharp vertical edges. They are suitable for high-torque installations into wood or metal. Their high hardness and strength combined with their lead threads allow for the perfect fastening of timber-to-metal or metal-to-metal. It is advisable to use a plain washer to prevent head from digging into the soft material.

Features

- ◆ High-performance drive surfaces reduce cam-outs & thus EASY INSTALLATION.
- ◆ Precise point designed to drill, tap and fasten ALL-IN-1 motion.

Applications

- ◆ Skin Sheet to Steel.
- ◆ Attaching metal and other materials to metal.
- ◆ Residential steel frame construction.
- ◆ For light duty purposes.

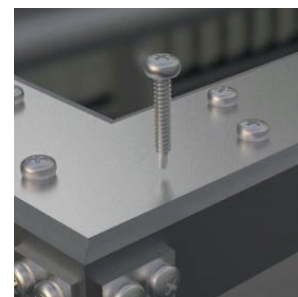

INSTALLATION INSTRUCTIONS

- ◆ Insert and center Screwdriver Bit PH2 (S2 x 65mm) in the drill machine's chuck.
- ◆ Clean any metal shavings build-up on the bit after-which attach a screw with screwdriver bit.
- ◆ Slow press trigger till drilling tip of the screw rests against metal. Increase speed when screw aligns to center.
- ◆ Stop drilling when the head of the self-drilling screw tightens against the surface of the metal.

Material Specifications

Parameter	Specifications
Diameter Range	4.2mm (#8)
Length Range	13mm – 50mm
Coating	Blue Zinc Electro-Plated
Thread Type	Coarse Thread
Fitting Accessory	Screwdriver Bit PH2 (S2 x 65mm)

Specifications

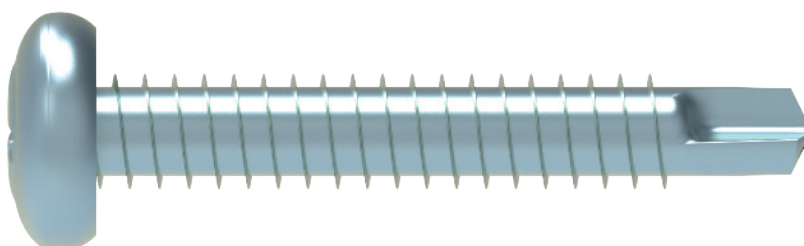
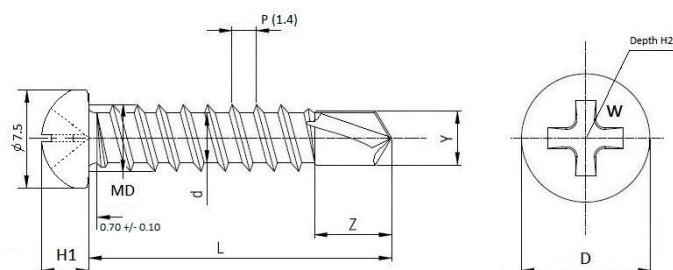

TRUSS HEAD SDS

WELFAST TRUSS Head Self Drilling Screw (also known as Wafer Head SDS) is a flatter and wider than a typical round or pan head screw but serves the same purpose. They feature an over-sized domed head with a flange, similar to an integral washer. These have a 100-degree undercut which creates a larger area beneath the screw's head for a larger bearing surface.

Features

- ◆ Wide head distributes holding pressure which **SAVES MATERIAL FROM DAMAGE**.
- ◆ Wafer head provides both a sleek low-profile finish and **EXCELLENT CLAMPING**.
- ◆ Non-walking point provides **FAST MATERIAL ENGAGEMENT**.

Applications

- ◆ For using in object like polycarbonate sheet, shadow cover.
- ◆ Residential steel frame construction.
- ◆ Secure metal wire to steel framing.

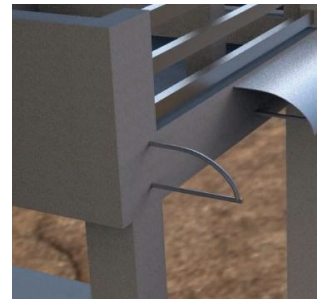

INSTALLATION INSTRUCTIONS

- ◆ Insert and center Screwdriver Bit PH2 (S2 x 65mm) in the drill machine's chuck.
- ◆ Clean any metal shavings build-up on the bit after-which attach a screw with screwdriver bit.
- ◆ Slow press trigger till drilling tip of the screw rests against metal. Increase speed when screw aligns to center.
- ◆ Stop drilling when the head of the self-drilling screw tightens against the surface of the metal.

Material Specifications

Parameter	Specifications
Diameter Range	4.2mm (#8)
Length Range	13mm – 50mm
Coating	Blue Zinc Electro-Plated
Thread Type	Coarse Thread
Fitting Accessory	Screwdriver Bit PH2 (S2 x 65mm)

Specifications

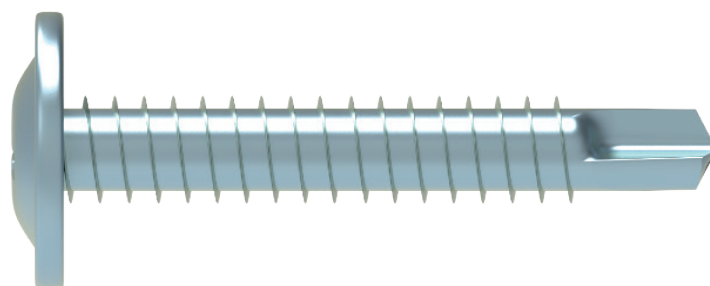
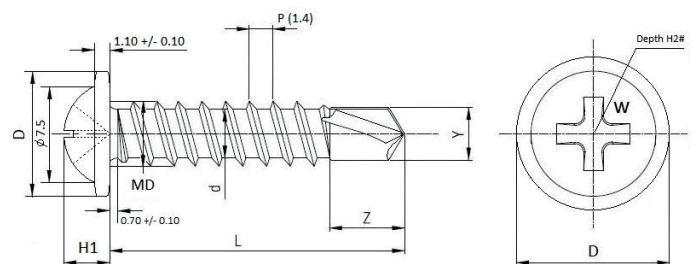

OTHER PRODUCTS



Sleeve Anchor



Drop in Anchor



Rawal Fan Hook



Rawal Bolt



Nylon Anchor



Chemical Stud



**High Tensile
Bolt (8.8)
(Half Thread)**



**High Tensile
Bolt (8.8)
(Full Thread)**



Welfast[®]

WELFAST FASTENERS PVT LTD
www.welfastfastener.com
Contact Us – +91 84202 26655

KOLKATA OFFICE
71 B, NETAJI SUBHAS ROAD, KOLKATA – 700001
+91 79802 66981 | +91 90075 89008

AHMEDABAD OFFICE
12 DADA ESTATE, SARKHEJ, AHMEDABAD – 380015
+91 94287 01881 | +91 97255 68518